

---

Fitting instructions

---

Make: Land Rover

---

Freelander; 2006->

---

Type: 4248

---

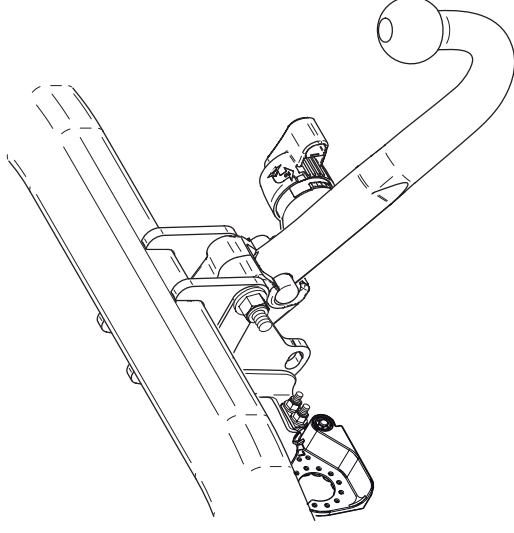

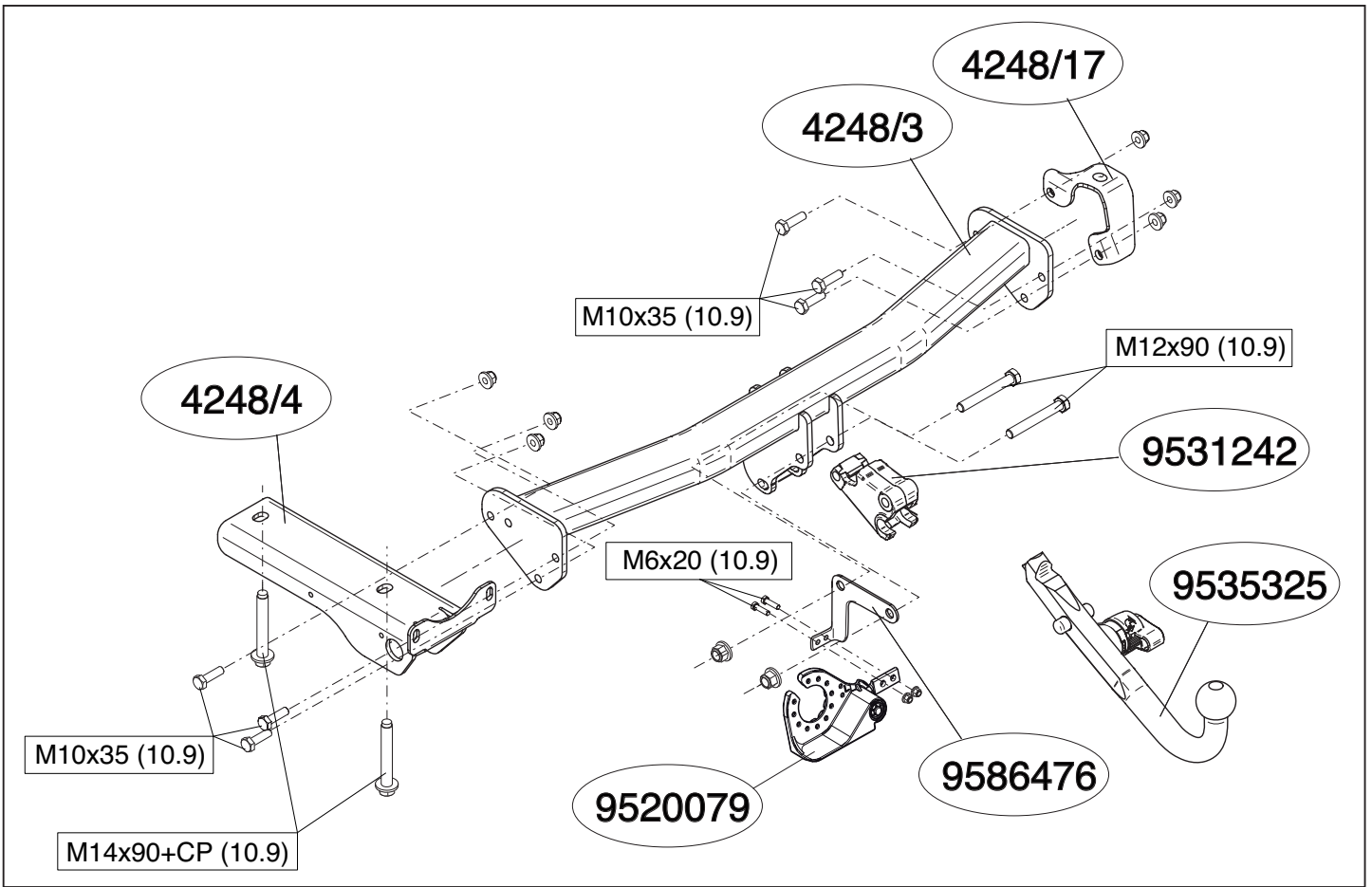

© 424870MN/20-02-2014/1

(2x) M12



(4x) M10



(2x) M6



(2x) M14x90+CP (10.9)

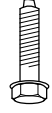

(2x) M12x90 (10.9)



(6x) M10x35 (10.9)



(2x) M6x20 (10.9)

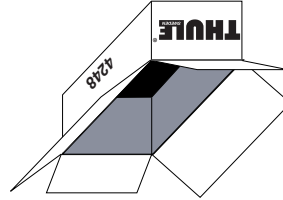
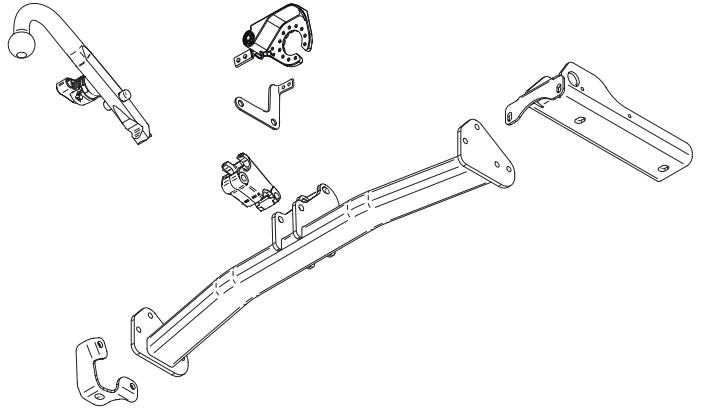
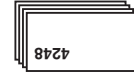
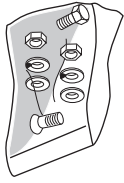

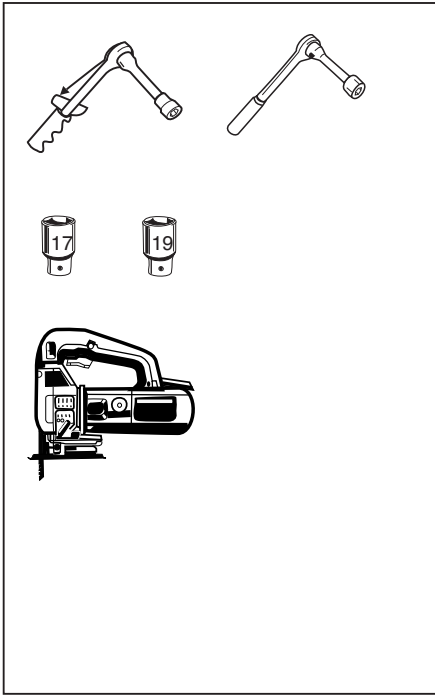

Couplingsclass: A50-X

euro tested

Approved

Approved

ECE R55 E11 55R 015807

**D-Value : 11,0 kN**

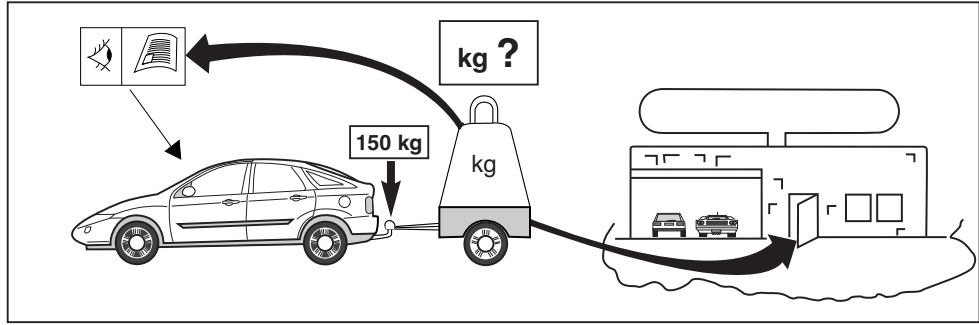

10.9

10

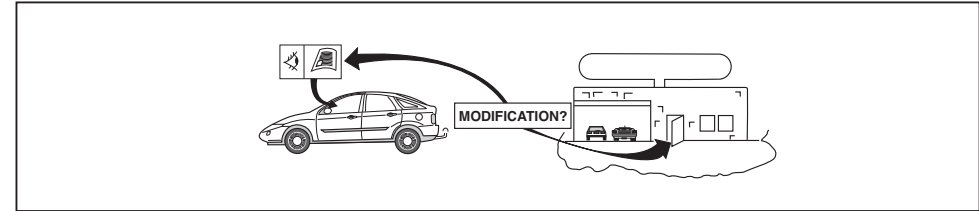

© 424870MN/20-02-2014/3

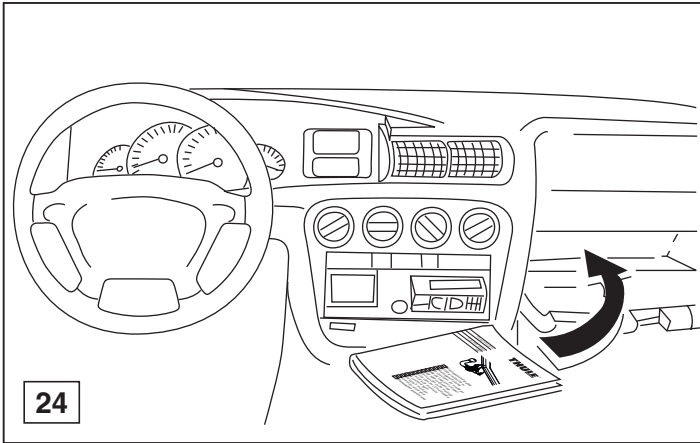

\* Für das Fahrzeug zugelassene Anhängelast ist den Fahrzeug Unterlagen zu entnehmen. Bei Änderungen des Fahrzeuggewichtes muß die höchstzulässige Anhängelast gegebenenfalls aus dem D-Wert nachgerechnet werden.  
 \* Elektrische Anlage gemäß StVZO anbringen.  
 \* Auskunft hierzu kann Ihr Fachhändler oder der TÜV geben.

**HINWEISE:**

\* Should this installation process entail the cutting of the bumper – conformation **MUST** be obtained by the installation engineer of the customer's acceptance prior to completion. Brink International do not accept responsibility for any matters arising as a result of this miscommunication.

**NOTE:**

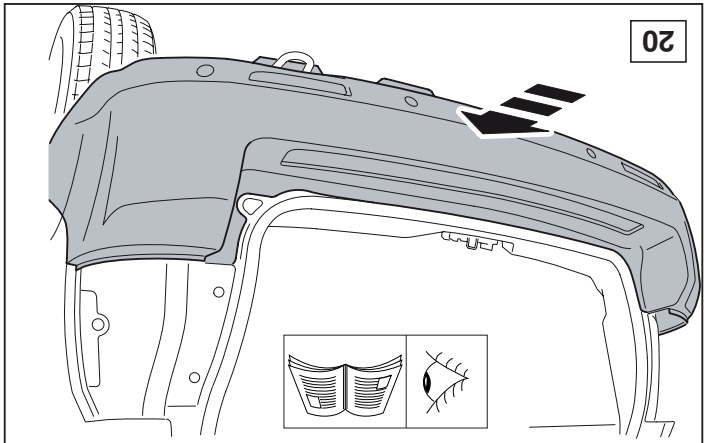
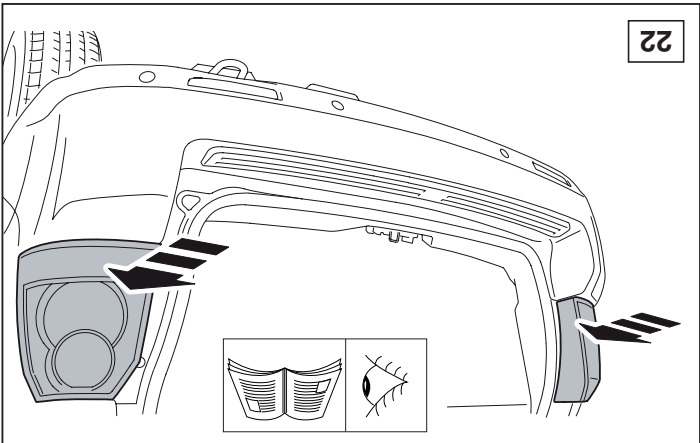
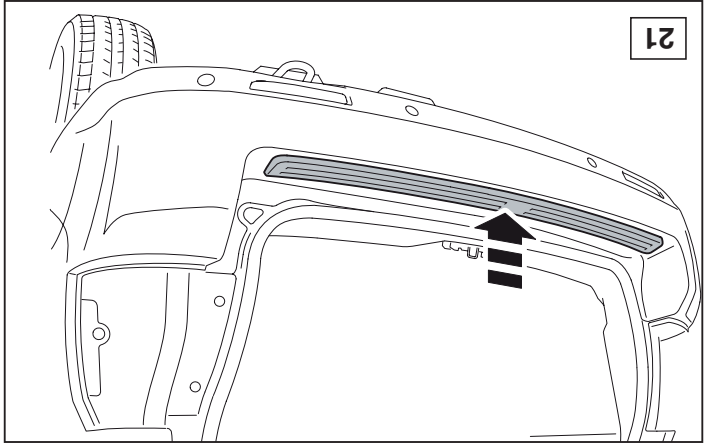
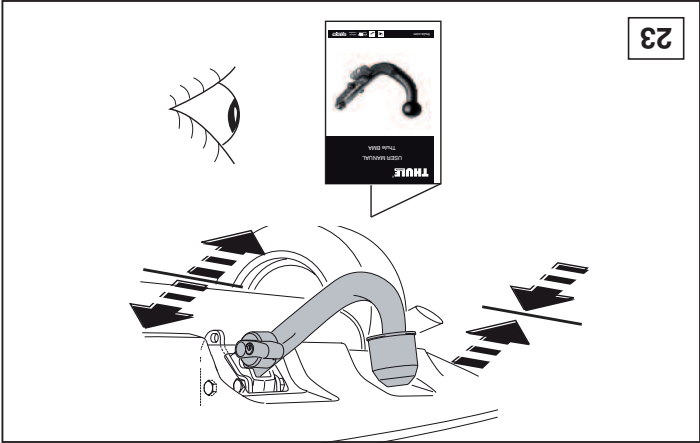
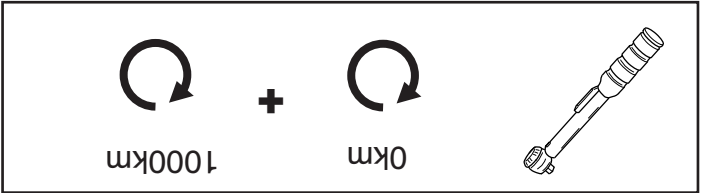

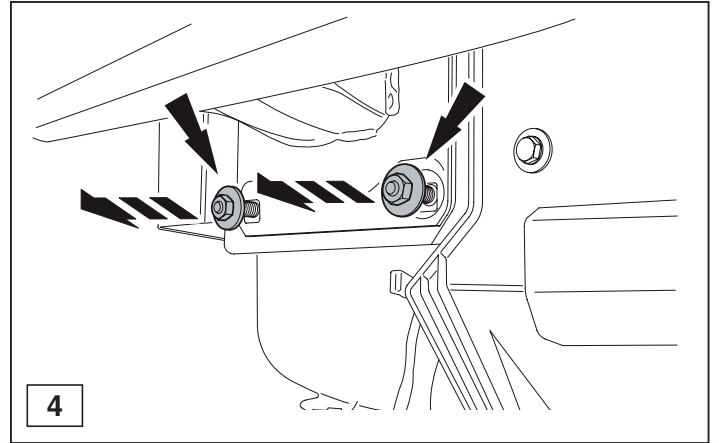
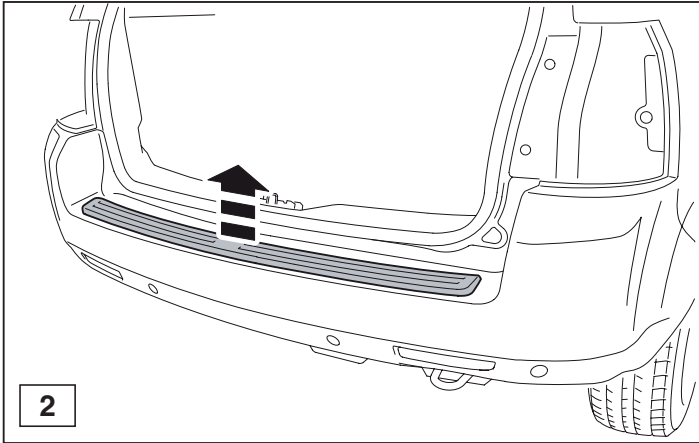
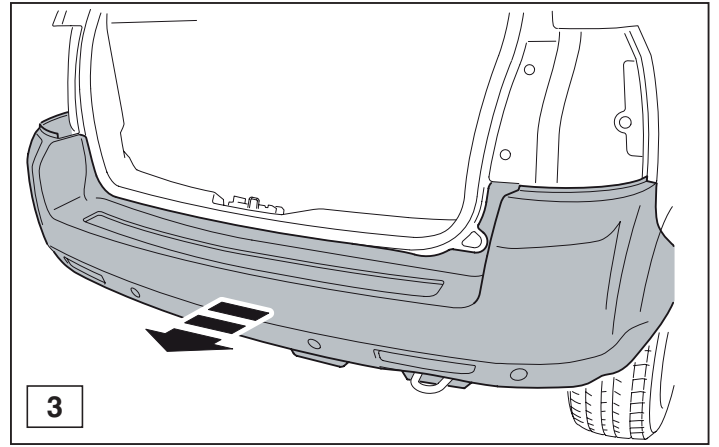
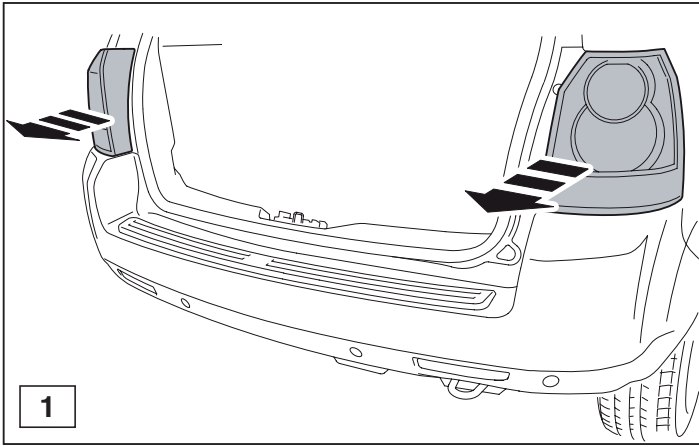

© 424870MN/20-02-2014/5

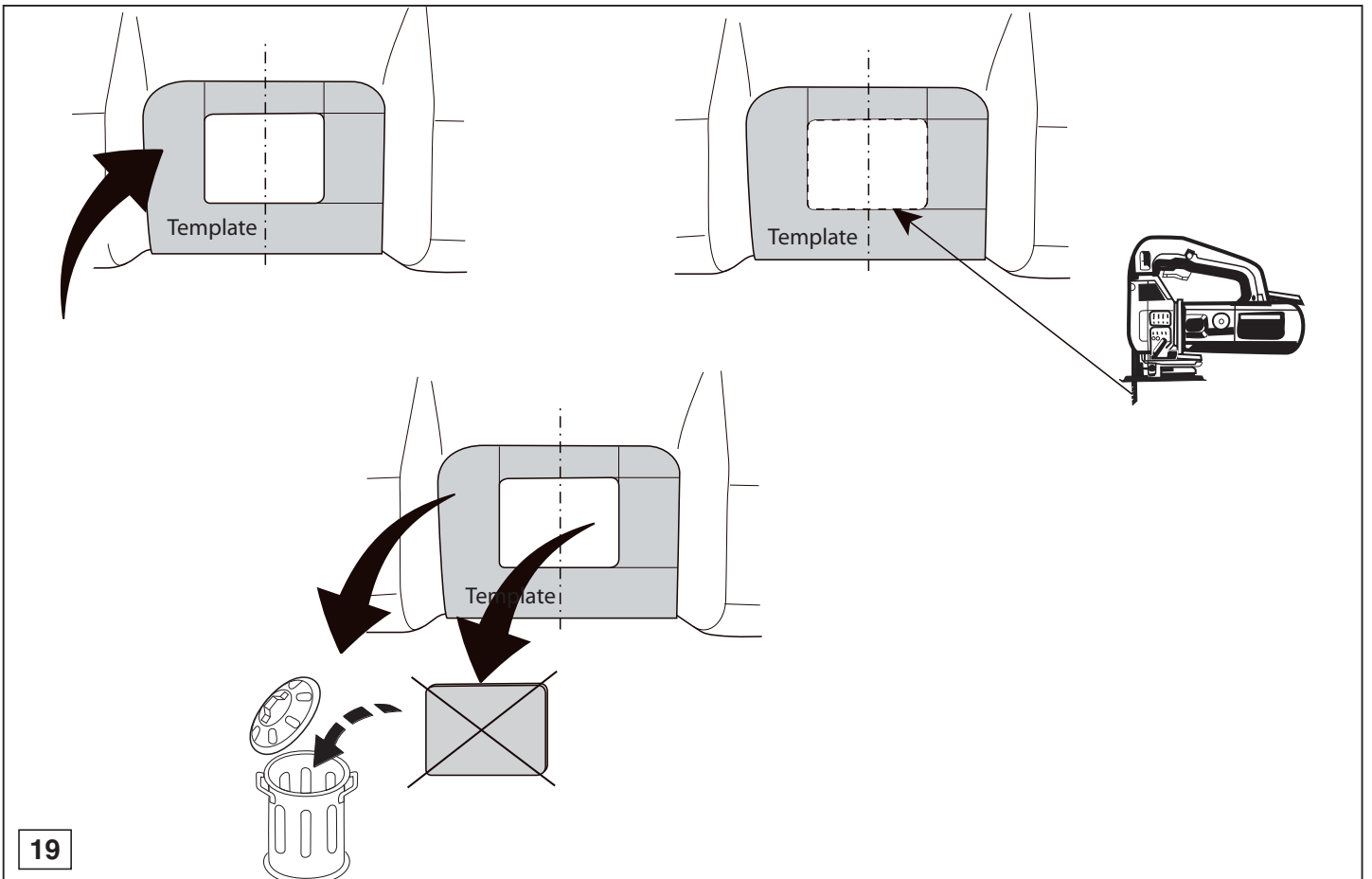

© 424870MN/20-02-2014/10

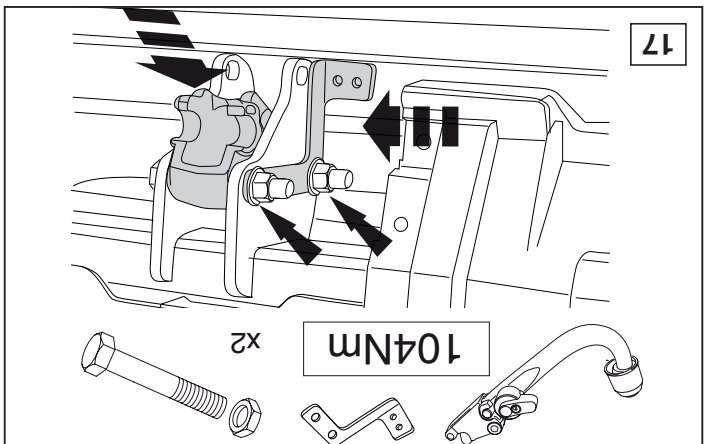
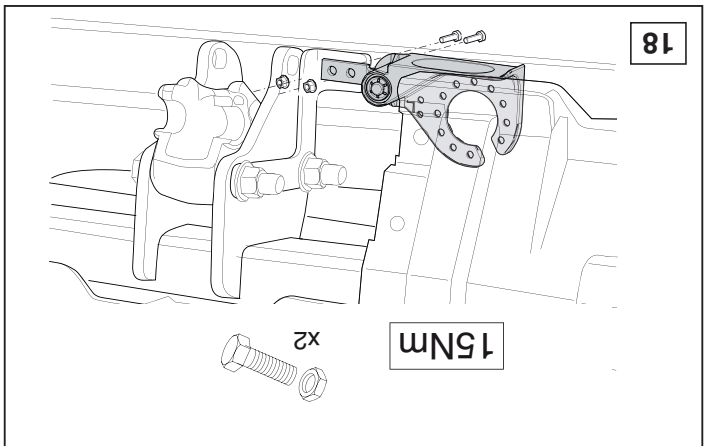
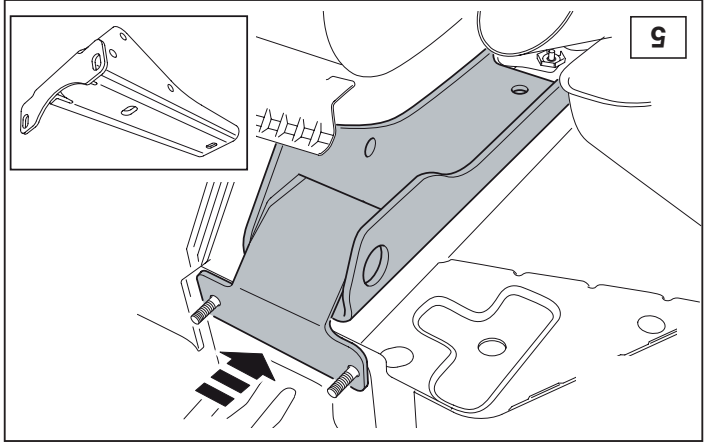
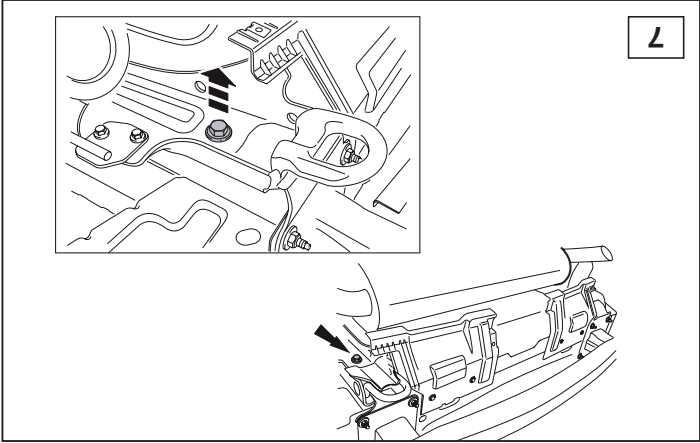
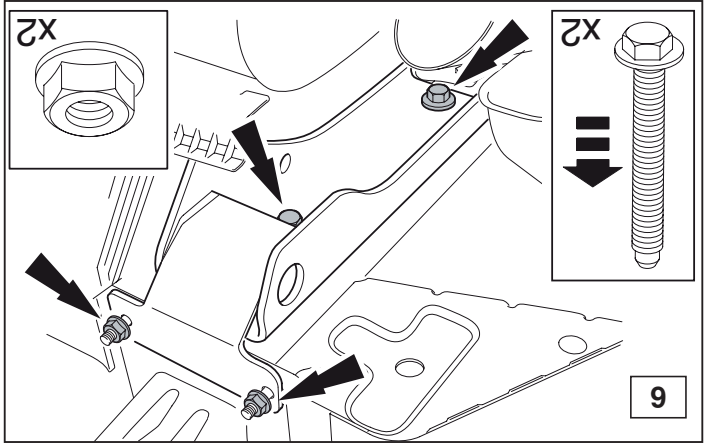
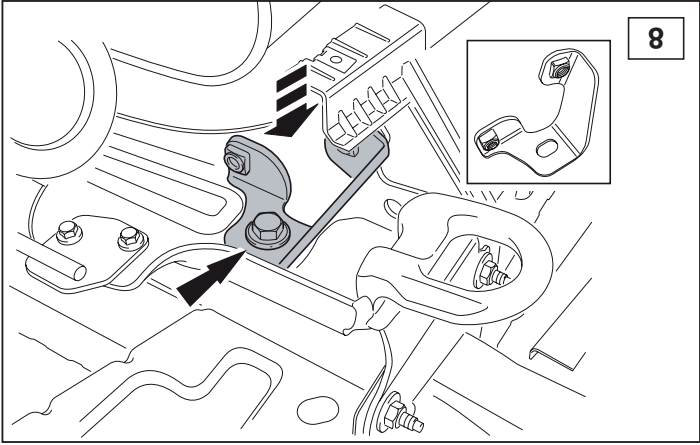

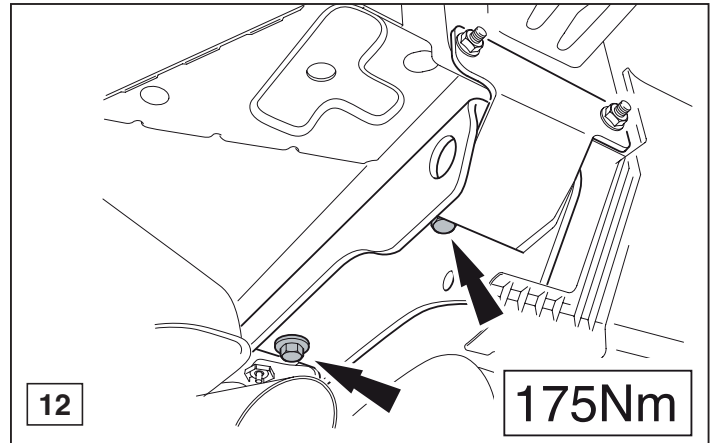
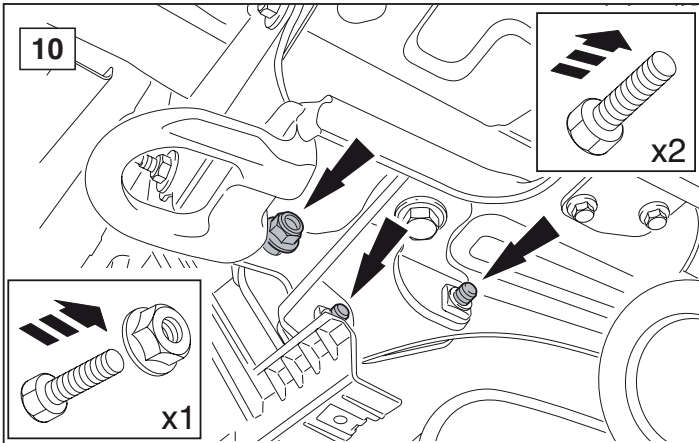
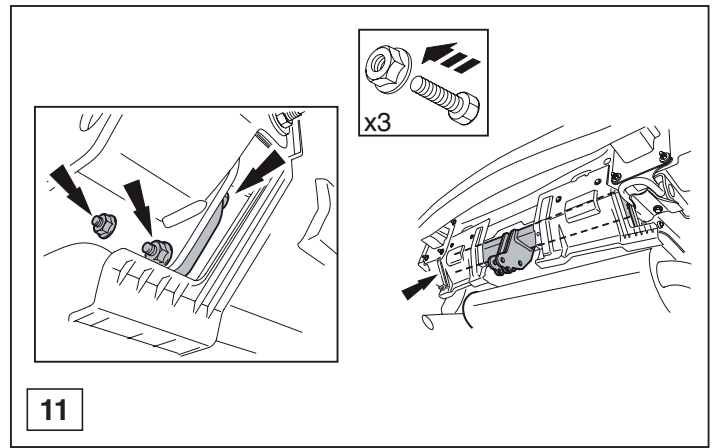
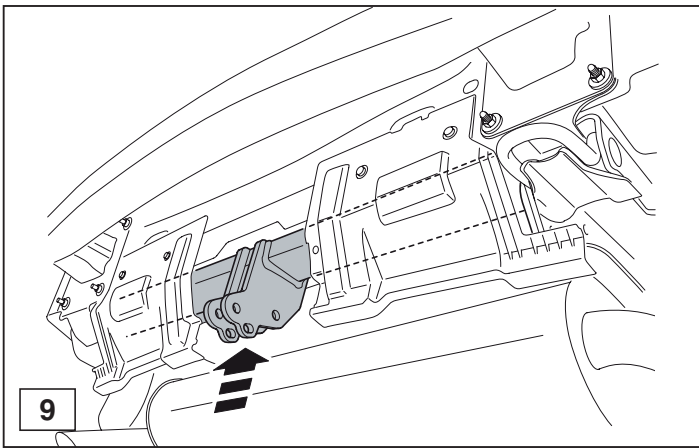

© 424870MN/20-02-2014/7

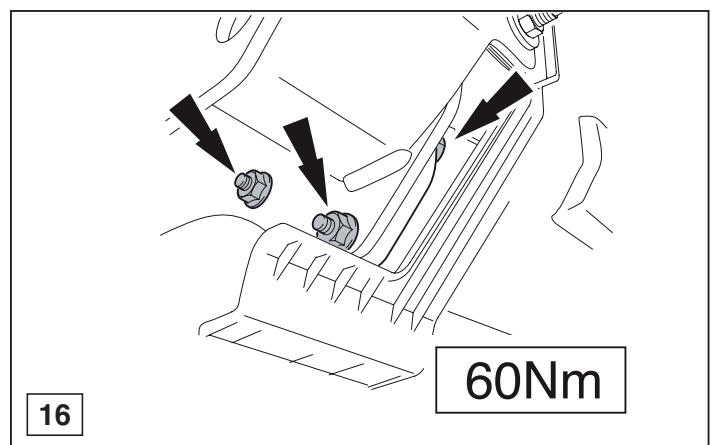
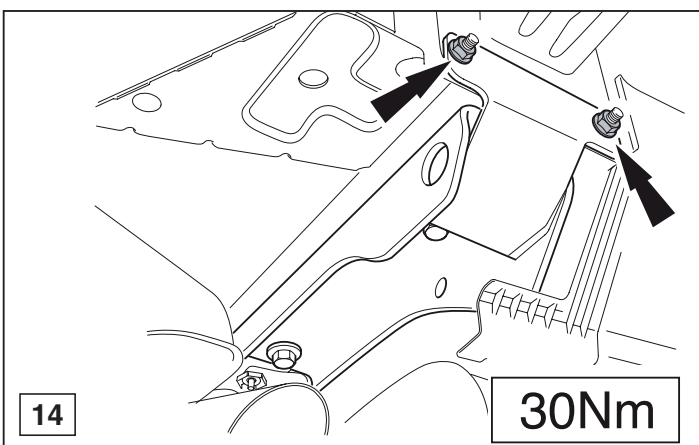
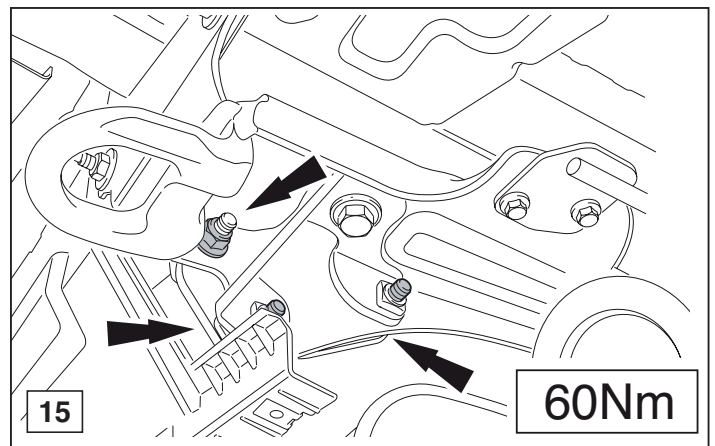
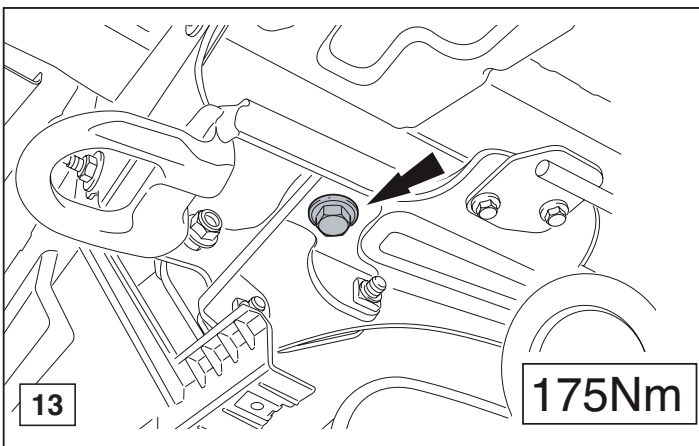

© 424870MN/20-02-2014/8





# Template 4248/4249/4357

DRILL 2 PLACES DIA 20mm

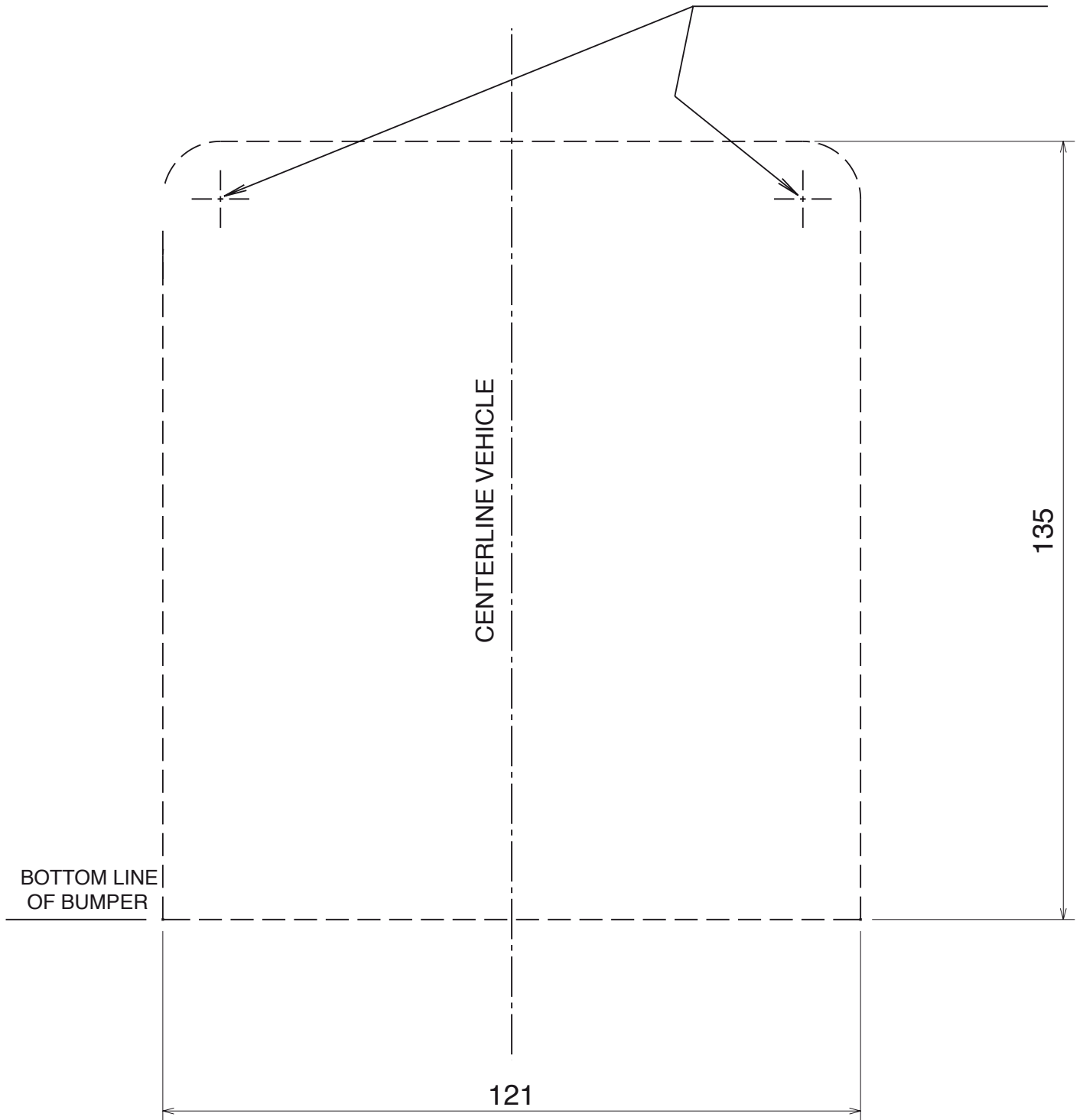

ALL DIMENSIONS IN mm UNLESS OTHERWISE STATED

